

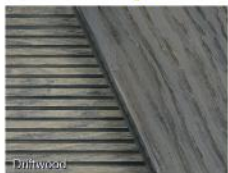

Heritage

Luxurious and Rustic

Heritage Board 150mm x 25mm				
Reversible	Clip	Screw	2.4m	3.6m
Yes	✓	✓	✓	✓



VINTAGE

Natural and Contemporary

Vintage Board 146mm x 23mm				
Reversible	Clip	Screw	2.4m	3.6m
Yes	✓	✓	✓	✓

CLASSIC

Strong and Heavy Duty

Classic Board 150mm x 25mm				
Reversible	Clip	Screw	2.4m	3.6m
Yes	✓	✓		✓



VICTORIA

Available in Woodgrain or Groove

Victoria Board 135mm x 23mm				
Reversible	Clip	Screw	2.4m	3.6m
No	✓			✓

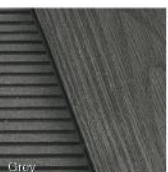

Preparation and Safety

Select the location of your decking carefully, taking into consideration existing structures. Ensure to research any building control/regulations should they apply and contact your local authority if you are unsure. Design your decking with a pitch at 1.25% of the full length to freely drain any water and always direct away from any existing buildings. Clear the area in advance and ensure the ground is solid prior to installing joists. Design should always allow for cross ventilation beneath the decking. Deck boards should always be stored flat on level bearers at 300mm apart or on level, solid ground. Always place, never slide the deck boards to avoid marking. Always wear gloves, eye protection and dust masks when cutting composite wood.

Maintenance

Clean regularly using a brush and hot, soapy water. Soft cleaning detergent can be used to wash light stains and marks, e.g. from leaves, berries, etc. For scratches and harder stains such as marks containing dyes that leave permanent stains, lightly buff using sand paper to carefully remove (always perform a surface test in a hidden area). Power washers should be kept at a distance of 30cm from the surface and no solvent based materials should be used for cleaning. Do not stain, oil or paint. It is normal to experience colour variations between boards, as Timco Wood will weather to a lighter shade and the colour of the boards will become more consistent with time.

Disclaimer

The information given within this guide is focused on installation for domestic properties. Commercial decking requires a more robust design and construction which is not covered within this document. The guidance within this document is designed as basic instructions which may not cover every installation scenario. Timco Wood recommends that all designs be reviewed by a licensed architect or engineer prior to installation.



- Easy Installation
- Low Maintenance
- Eco Friendly
- Concealed Fixing System
- 25 Year Domestic Warranty

www.timcowoodtrade.com

+44 (0)1438 311 203 info@timcowoodtrade.com
Unit 4 Senate Place, Whitworth Road, Stevenage, SG1 4QS



01438 311 203
timcowoodtrade.com

*Product images are for illustrative purposes only and may be subject to change.

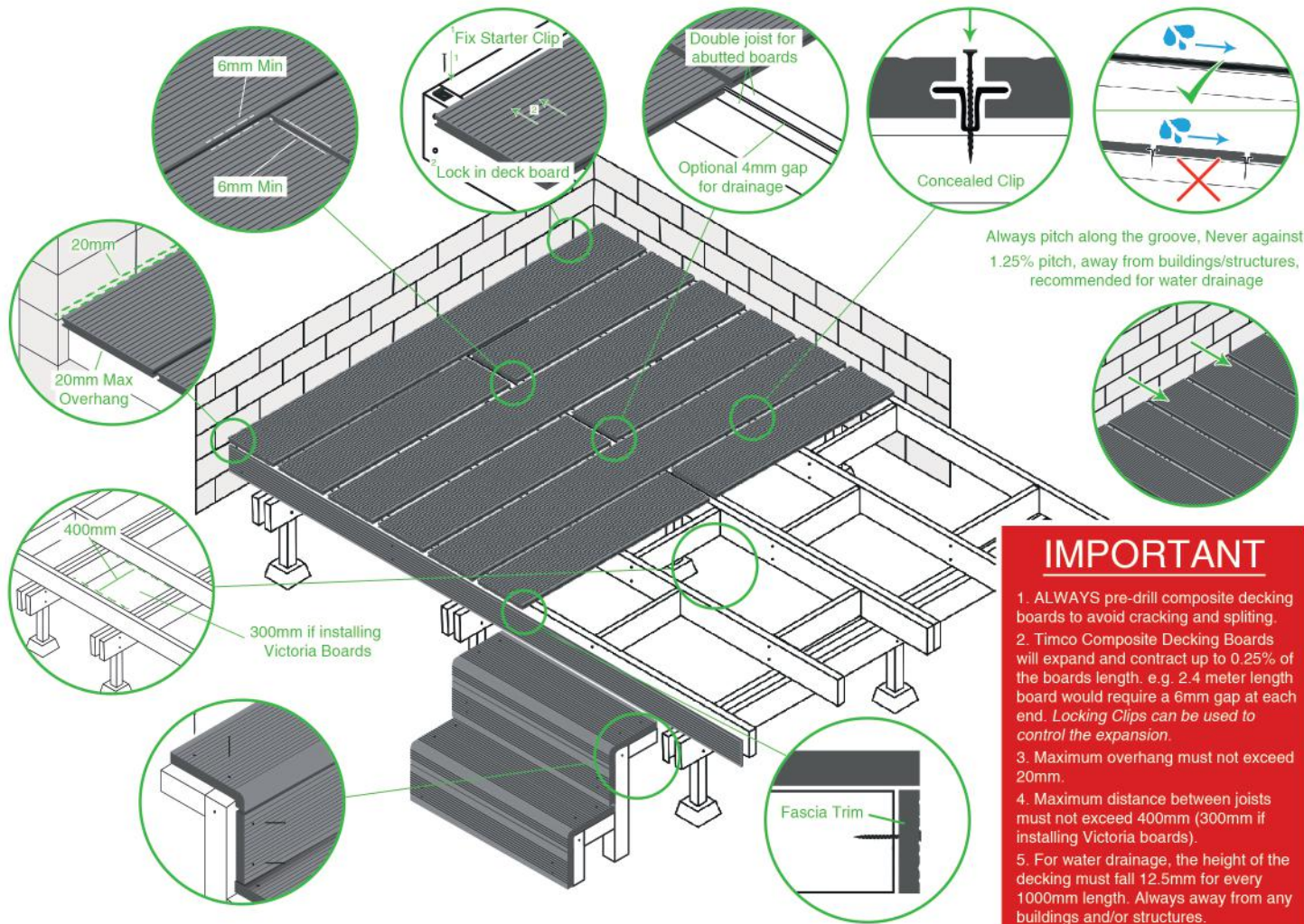

IMPORTANT

1. ALWAYS pre-drill composite decking boards to avoid cracking and splitting.
2. Timco Composite Decking Boards will expand and contract up to 0.25% of the boards length. e.g. 2.4 meter length board would require a 6mm gap at each end. Locking Clips can be used to control the expansion.
3. Maximum overhang must not exceed 20mm.
4. Maximum distance between joists must not exceed 400mm (300mm if installing Victoria boards).
5. For water drainage, the height of the decking must fall 12.5mm for every 1000mm length. Always away from any buildings and/or structures.

Concealed Clip System

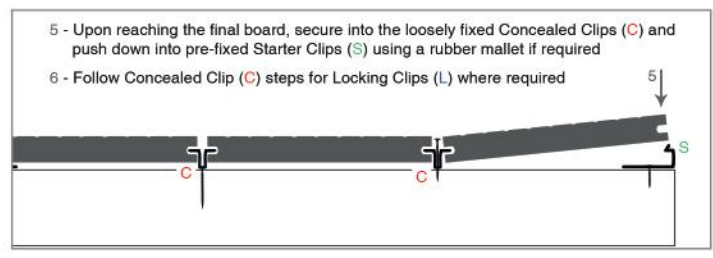
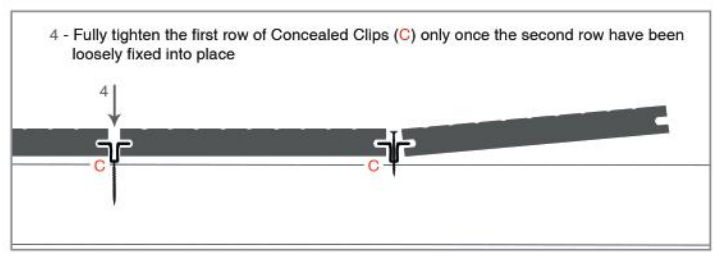
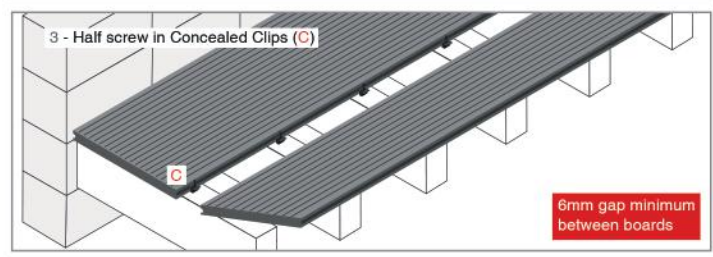
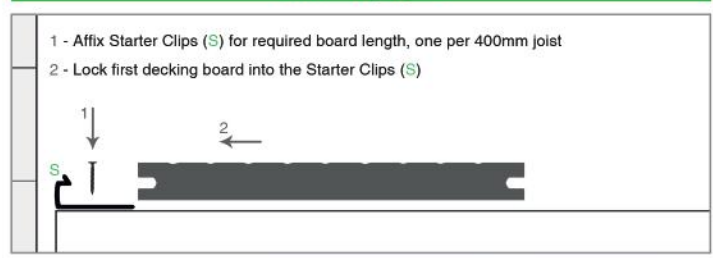

- Notes:**
1. Timco Heritage, Vintage and Classic boards can be installed using either the concealed clip or the traditional surface screw system.
 2. 2.4m board lengths can be installed using nylon clips, locking clips or surface screw system.
 3. 3.6m board lengths should be installed using the locking clip system or surface screw system.
 4. Timco Victoria range should be installed using the locking clip system.
 5. Fascia trims and step boards should be installed using the screw system.
 6. Full installation guidelines and instructions can be found on our website www.timcowoodtrade.com. Alternatively, please call us on 01438 311 203 for any advice or instructions.

Traditional Screw System

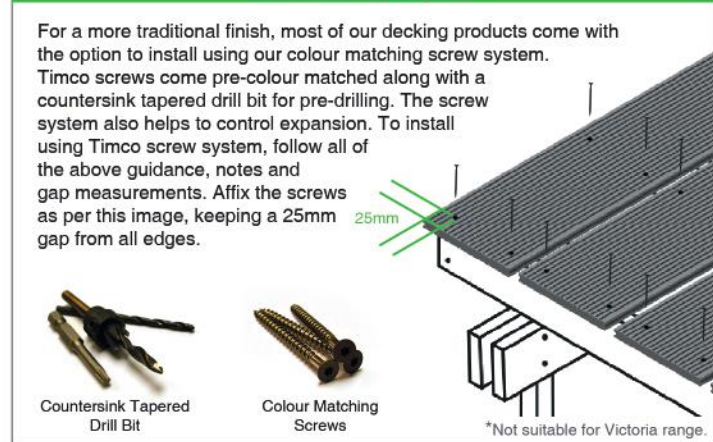

Expansion

